

# 10. Recommendations



isthmus

WOODS  
BAGOT.

360°

## 10.1 Delivery tactics and project priorities

Project priorities and next steps (comprehensive planning) should be guided and informed by:

1. **Timetable for the delivery of flagship projects.** Landscaping improvements will be progressively implemented as key University of Canterbury projects are delivered. A priority will be to ensure that the immediate surrounds of RRSIC, CETF, NEB projects will be integrated into the University campus.
2. **A focus on the campus heart** projects and initiatives identified in the Campus Master Plan that are integral and catalytic in redefining the perception and function of the campus. These projects consolidate outdoor activities in the communal campus heart that help realise the University's vision, contribute to its identity, and create an 'urban buzz'- with a dynamic outdoor environment for learning and social exchange, and showcasing University achievements. These connectors facilitate movement along the University axis, reinforce the main entry, and centre on the University Street and Central Plaza.
3. **Attention to District Plan.** Compliance issues with respect to car parking and bike rack locations will be a priority. Regard to heritage protection for Ilam Gardens and Okeover House / Ilam Green will

also be a priority as part of wider campus projects (waterways) and specific projects (memorial site)

4. **A focus on the waterways** as the most enduring and defining characteristic of the University of Canterbury, that embody the values of a healthy campus. The waterways provide a focus and a starting point for innovative teaching and learning, recreation, wayfinding and identity, cultural expression, environmental health, and community wellbeing. The waterways contain and define the campus heart and assist with wayfinding. The health of the waterways should guide and inform all future decisions around movement and stormwater treatment in the campus.
5. **Early wins** are temporary low cost projects, and form part of a collaborative community approach to the innovative transformation of outdoor spaces. Tactical urbanism and activation can be used as part of a project life cycle to test, inform and develop campus spaces over time. Priorities for early wins should focus on enabling and catalysing key projects, and concentrating activity in the campus heart and along waterways.

All works are subject to available funds and where relevant an approved business case.



STREAMS AND LANDSCAPE

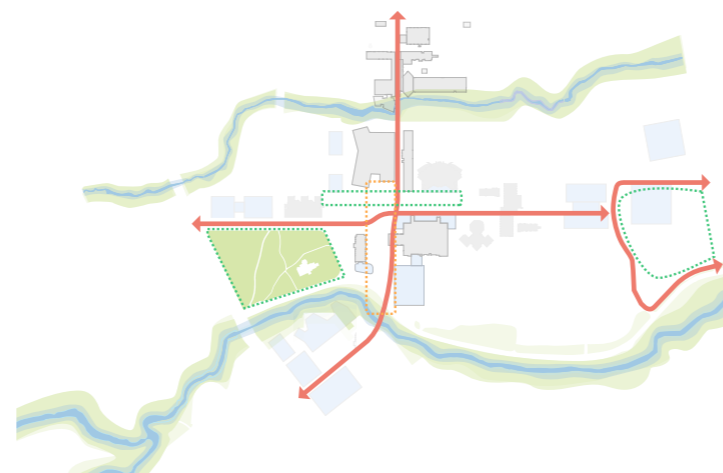

THE UNIVERSITY AXIS and MAIN ENTRY

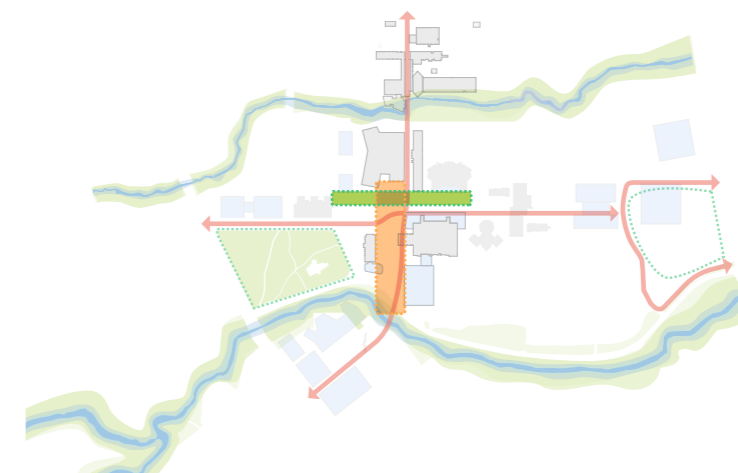

CAMPUS CENTRE

### 10.1.1 Delivery tactics and project priorities - matrix

The project priority recommendations in the table below set out how to get started with implementing change within the Campus landscape, and where to focus efforts in support of the 2023 'Jubilee' UC Campus Master Plan. Recommendations made are subject to available funds.

STAGE	EARLY WINS	PROJECT INTEGRATION	INCREMENTAL CHANGE
<p><b>Transition from recovery phase</b> <b>Now-2018</b></p>	<p><b>Focus projects</b></p> <ul style="list-style-type: none"> <li>• Traffic calming and closure of 'rat runs' with temporary landscape devices- University Drive, Engineering Road, Arts Road</li> <li>• Experiment with activation and use of the plaza and law helipad spaces- relocatable furniture etc.</li> <li>• Install temporary basketball courts</li> <li>• Install distance markers for campus running trail</li> <li>• Interactive hoardings and temporal artworks</li> </ul>	<p><b>Focus Projects</b></p> <ul style="list-style-type: none"> <li>• Campus Heart Concept Plan: comprehensive design brief for Entrance Boulevard, University Street, Central Plaza, River Plaza, Ilam Green (plaza and loop road). These projects should be scheduled after the completion of nearby/ adjacent building works in order to avoid re-work. Ref: UC 10 year LTCP.</li> <li>• Integration and funding for completion of 'major build' landscapes (CTEF, NEB, RRSIC)</li> <li>• Wellness Precinct Master Plan (see further investigations)</li> </ul>	<p><b>Focus Projects</b></p> <ul style="list-style-type: none"> <li>• Waterways- ephemeral stream restoration</li> <li>• Sediment management for waterways - including investigating low maintenance alternative to sediment traps</li> <li>• Ilam Gardens- memorial garden site</li> <li>• Orchards/ food forests/ edible</li> <li>• Mahinga kai learning and demonstration sites</li> <li>• Decommission of temporary villages at Dovedale and Kirkwood, mitigation and repair to former condition of fields</li> </ul>
	<p><b>First steps</b></p> <p>Create a detailed 'early wins' design led programme based on the LMP that gets in ahead of permanent rebuild and construction projects to change travel behaviours, test and adapt the use of communal spaces, and inform future project briefs. Identify seed funding for 'catalyst' interventions. Involve students from idea generation through to implementation. Tactical urbanism could be included as part of a comprehensive design brief and engagement process for the Campus Heart Concept Plan project.</p>	<p><b>First steps</b></p> <p>Develop a comprehensive design brief including further investigations (see below) that will define the scope, budget, staging and design parameters for the Campus heart projects and inform a UC Business Case for capital expenditure. Design-led collaboration including landscape, traffic, wayfinding, architecture, art, trees.</p> <p>Peer review landscape concept proposals for 'major build' projects against the LMP, rationalise scope, budget and integration requirements and prepare costing and Business Case for additional capital expenditure and staged completion.</p>	<p><b>First steps</b></p> <p>Scope the memorial garden project and potential fundraising avenues (such as public events in Ilam Gardens). Commission a Conservation Plan for Ilam Gardens and further investigations (see below).</p> <p>Waterways management strategy and work programme approved by relevant University stakeholders, focusing initially on ephemeral streams.</p> <p>Scope potential new site for 'food forest' orchard along waterways and /or student accommodation and residential parkland buffer areas.</p> <p>Review and rationalise future sportsfield in conjunction with UC sport and other interested parties.</p>

STAGE	EARLY WINS	PROJECT INTEGRATION	INCREMENTAL CHANGE
<p style="text-align: center;"><b>Regeneration 2018-2023</b></p>	<p><b>Focus Projects</b></p> <ul style="list-style-type: none"> <li>• Complete exercise trail circuit around campus</li> <li>• Temporary recreation activation- courts, games, pop up activities, nature play etc.</li> <li>• Temporary social activation- BBQ's, food trucks, music events, exhibitions etc.</li> <li>• Carpark contaminant and stormwater treatment- experimental interventions and environmental awareness events.</li> </ul>	<p><b>Focus Projects</b></p> <ul style="list-style-type: none"> <li>• Staged design and construction of Campus heart projects. (with priority given to development of projects independent of new buildings – i.e. Entrance boulevard, Ilam Green and loop road, River plaza crossing).</li> <li>• Completion of 'major build' landscapes (CTEF, NEB, RRSIC).</li> <li>• Completion of 2023 landscape projects associated with Wellness Precinct and Recreation Centre, Ilam Fields clubrooms (relocation and review of Foundry) and Grounds Depot, and 'Campus Heart' design project for Dovedale.</li> <li>• Formalise road closures and reconfigured carpark and cycle stand landscaping.</li> </ul>	<p><b>Focus Projects</b></p> <ul style="list-style-type: none"> <li>• Establish monitoring and indicator mechanisms for completed projects e.g. stormwater and contaminant treatment within campus heart, and terrestrial/ aquatic habitat quality.</li> <li>• Address contaminants entering waterways from carparks - focusing on priority locations with direct discharge to streams.</li> <li>• Continue waterways restoration programme, including learning spaces and water access.</li> <li>• Connect parkland trails and formalize commuter desire lines.</li> <li>• Continue planting programme, focusing on parkland entry- cultural and iconic marker plantings, and amenity buffers to residential areas.</li> </ul>
	<p><b>First steps</b></p> <ul style="list-style-type: none"> <li>• Events management strategy</li> <li>• Review programme and funding streams to activate spaces ahead of construction</li> <li>• Create a mechanism that empowers students and staff to make 'tactical intervention' applications for approval by UC management, particularly where aligned with course work.</li> </ul>	<p><b>First steps</b></p> <ul style="list-style-type: none"> <li>• Align staging and budget with programme of works for new buildings</li> <li>• Define extent of works for Campus Heart projects that are independent of new building footprints and infrastructure.</li> <li>• Prioritise 2023 landscape projects that are independent of new buildings- i.e. Ilam Fields.</li> </ul>	<p><b>First steps</b></p> <ul style="list-style-type: none"> <li>• Secure operational expenditure where this contributes most significantly to waterways and entrances.</li> <li>• Confirm new site for an orchard/ food forest project.</li> <li>• Review and cost accessible path and bridge upgrades for Ilam Gardens.</li> </ul>

## 10.2 Next steps

**The Landscape Master Plan is a flexible spatial framework for ongoing development and management. To develop the high level concepts in the Landscape Master Plan it is recommended that further investigations be carried out in the next year (2016-2017) to better inform project specific scope and parameters. These investigations include the following:**

1. Detailed investigation and consultation with ECAN and CCC regarding future potential public transport/ bus route and bus stop relocation options - based on the options and recommendations put forward in the Landscape Master Plan in conjunction with the Transport Strategy. This will inform the design of the entrance boulevard and loop, as the inclusion of frequent bus traffic would significantly impact on the width, layout and materiality of this space.
2. Review service access requirements to RRSIC once a decision is made on the potential removal of Rutherford and any replacement buildings, in conjunction with waterways and potential landscape proposals for the 'stream to stream' urban wetland.
3. Integrated Master Planning of the UCSA, Recreation Centre, Wellness Precinct and Ilam Road (in consultation with ECAN and CCC where appropriate) to fully consider the potential for integrated bus stop provision as above, and traffic calming in the vicinity of the UCSA pedestrian crossing.
4. The Landscape Master Plan identifies that some proposed new buildings, pathways/ boulevards and plaza spaces overlap with existing trees that may require removal or integration, particularly in

the Campus Heart. Further consultation should be undertaken with key grounds staff and HODs as to the significance of educational plant groupings that are too close to buildings.

5. Further design and policy review for the use, layout, quality standard and efficiency of campus fields (Ilam, Dovedale, Kirkwood) to inform spatial allocation and supporting facilities required for UC and community sporting codes, including: rugby, football, cricket, hockey, athletics. This review may be extended to consider the event policy for fields.
6. Comprehensive planning and curation for integration of art opportunities within the campus, specifying locations where art 'typologies' apply and can be incorporated as part of development projects or standalone interventions. An art guide or policy should include specialist input from UC's Art Committee, a curator and landscape architect to refine the Landscape Master Plan recommendations, and establish a process for artists to work collaboratively as part of project teams, or be appointed for specific commissions that reinforce the identity and vision of the University.

### Further investigations - Ilam Gardens

Further investigations for Ilam Gardens are recommended in the Ilam Gardens Landscape Management Strategy and include:

- Consult with CCC and ECAN regarding proposed naturalisation of ephemeral streams
- Review and consult on proposed location for memorial garden, scope and brief, and develop design for fundraising.
- Formalise path along Ilam Fields
- Investigate potential to re-purpose building for public toilets.
- Event management strategy to include Ilam Gardens 'tree lawn'.
- Investigate traffic calming and shared surface for Homestead Lane

## 10.3 Explore Ilam Road bus stop options

Investigating possible bus stop configurations on Ilam Road

Option 01: Bus stop between Okeover lawn and Ilam Fields

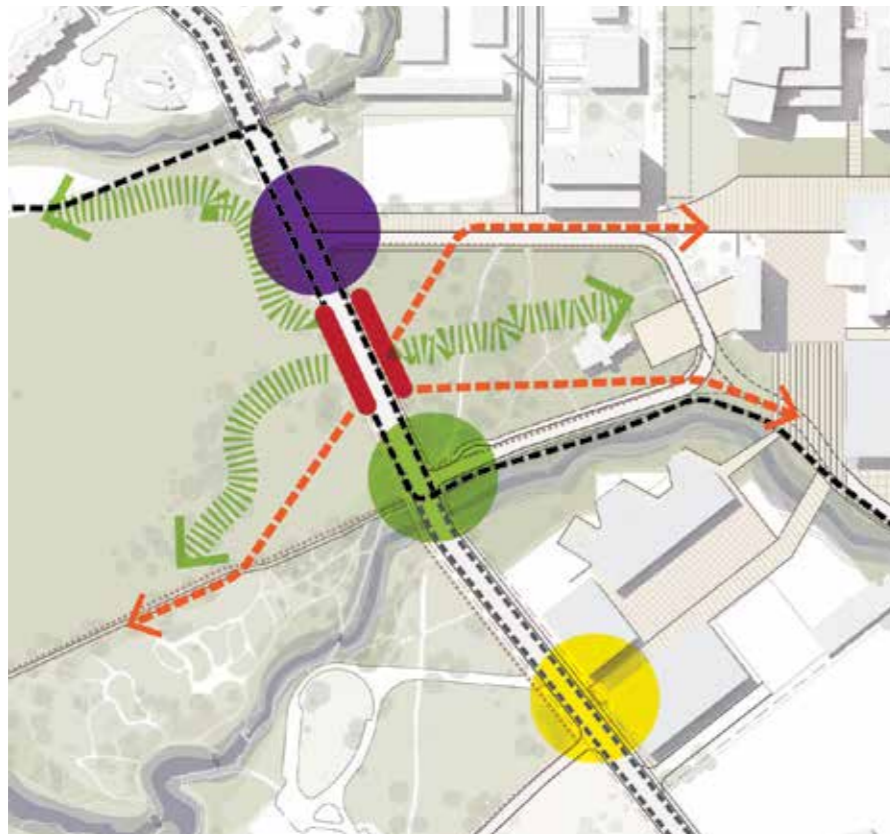

**Pros:**

- Safety - visibility up and down street
- Views into campus

**Cons:**

- Interrupts continuous green character from Ilam Fields to Okeover lawn
- Separated from key entrances
- Desire lines across Okeover lawn and Ilam fields
- Indirect connection to access network
- Conflict with cycleway both sides of road

Option 02: Bus stop integrated with UCSA

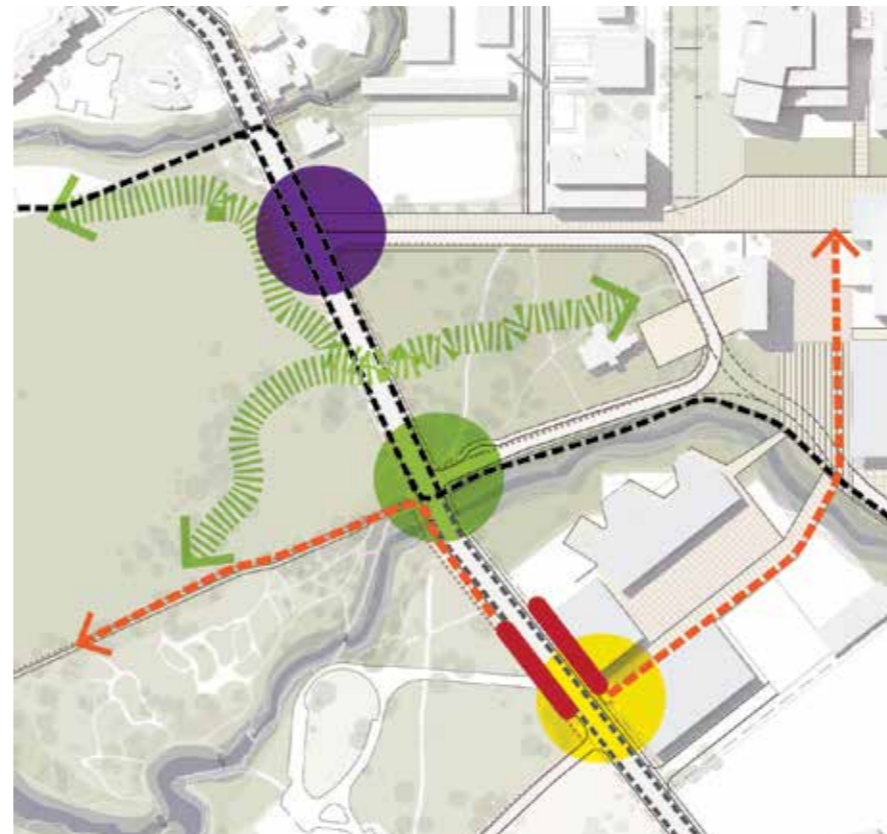

**Pros:**

- Strong connection to UCSA, wellness precinct and accommodation
- Direct access into campus via wellness precinct
- No conflict with cycleway
- Journey times remain as per status quo
- Less conflicts with cycle and pedestrian traffic

**Cons:**

- Disconnected from main (formal) entrance
- Bus stop safety and visibility issues need to be resolved
- Concentrates foot traffic in wellness precinct/around UCSA building

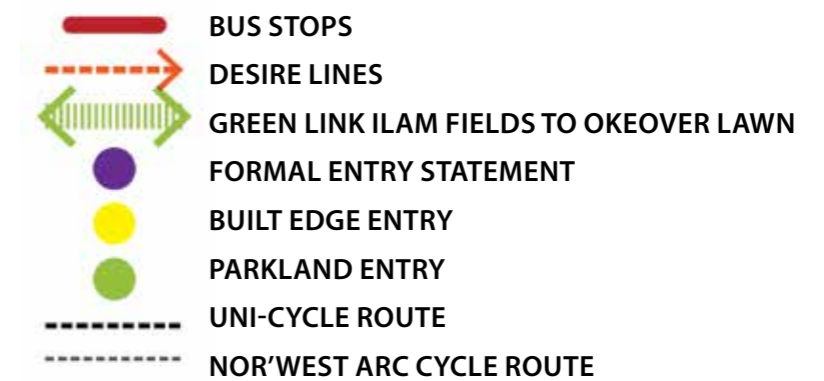

RECOMMENDATIONS

**Option 03: Bus stop in campus, entering on the boulevard and exiting on the loop**

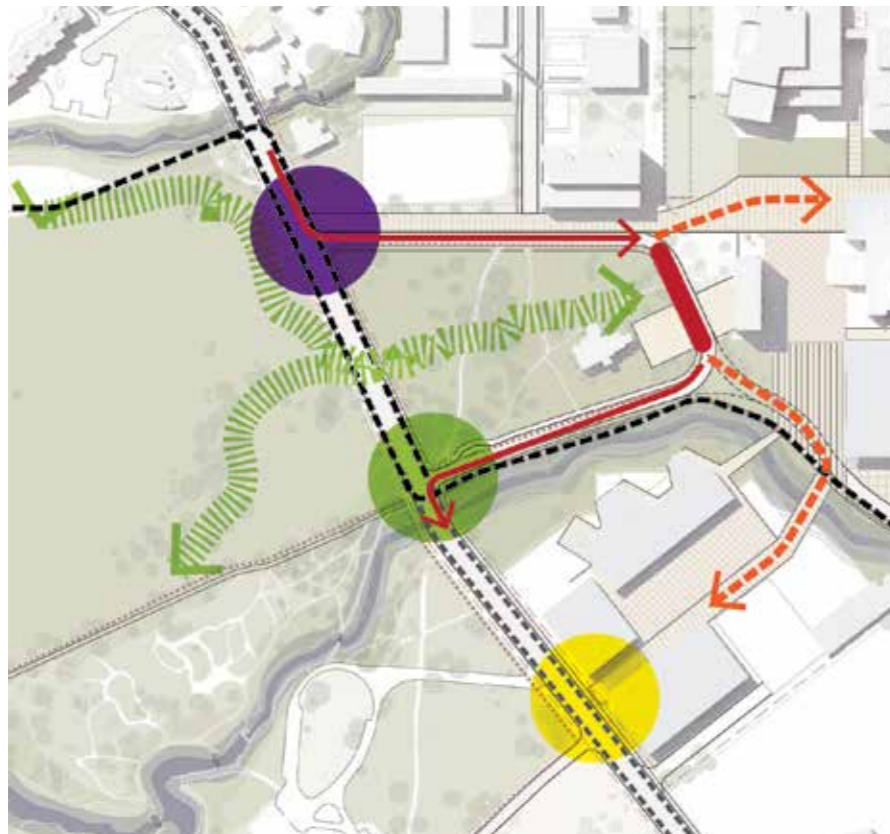

**Pros:**

- Arrival directly into the heart of the University - reinforces entrance experience
- Direct access to University
- Disembark/embark removed from road

**Cons:**

- Adds time to bus route
- Bus turning issues at entrance and exit
- Creates conflict with cyclists and traffic on road
- Brings traffic into the boulevard - safety issue
- Disconnected from Ilam Fields and accommodation
- Conflicts with "pedestrian campus"
- Conflicts with Buses crossing cycleway at entry and exit

**Option 04: Bus stop north of main campus entrance**

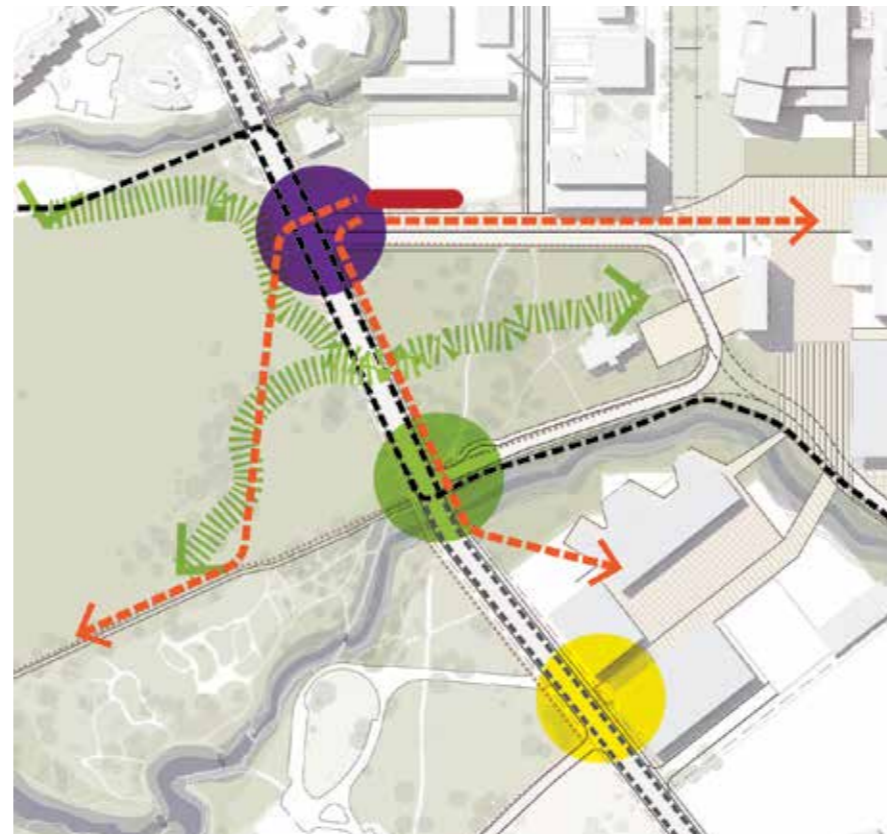

**Pros:**

- Arrival directly onto Boulevard - reinforces entrance experience
- Direct access to University
- Disembark/embark removed from road

**Cons:**

- Adds time to bus route
- Bus turning issues
- Creates conflict with cyclists and traffic on road

